

18-8 Stainless Steel

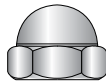

HEX CAP NUTS

Low Crown
Stainless cap nuts may be made in 2 pieces or "milled from the bar"

Part #	Size	Ctn Qty	Wght Lbs/M	Part #	Size	Ctn Qty	Wght Lbs/M
04NC188	4-40	500	2.44	14NC188	1/4-20	500	8.43
06NC188	6-32	500	2.30	31NC188	5/16-18	500	11.79
08NC188	8-32	500	3.10	37NC188	3/8-16	300	18.00
10NC188	10-24	500	4.05	50NC188	1/2-13	100	42.22
11NC188	10-32	500	3.91				

316 Stainless Steel



FINISHED HEX NUTS

Double Chamfered
Manufactured to ASME B18.2.2 dimensions

Part #	Size	Ctn Qty	Wght Lbs/M	Part #	Size	Ctn Qty	Wght Lbs/M
14NF316	1/4-20	5,000	7.00	75NF316	3/4-10	100	110.00
31NF316	5/16-18	3,000	10.29	87NF316	7/8-9	100	182.00
37NF316	3/8-16	2,000	15.00	100NF316	1-8	50	268.00
50NF316	1/2-13	500	36.50	112NF316	1 1/8-7	50	388.30
62NF316	5/8-11	500	69.75	125NF316	1 1/4-7	20	517.50

300-series Stainless Steel

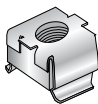

CAGE NUTS

Free floating Square Nut retained within a Spring Steel Cage
Square Nut: 304 J3 Stainless Steel
Cage: Class 304 3/4-hard Stainless Steel

Part #	Size	Ctn Qty	Wght Lbs/M	Part #	Size	Ctn Qty	Wght Lbs/M
10NCAG188	98579-1024	500	9.88	14NCAG188	D07988-1420	500	10.00
11NCAG188	C30452-1032	500	9.80	31NCAG188	D07957-5618	500	20.00

18-8 Stainless Steel



HEAVY HEX NUTS

Manufactured to ASME B18.2.2 dimensions

Part #	Size	Ctn Qty	Wght Lbs/M	Part #	Size	Ctn Qty	Wght Lbs/M
14NHH188	1/4-20	1,000	10.33	62NHH188	5/8-11	100	107.50
31NHH188	5/16-18	1,000	15.50	75NHH188	3/4-10	100	184.00
37NHH188	3/8-16	500	28.40	87NHH188	7/8-9	100	272.50
50NHH188	1/2-13	500	62.75	100NHH188	1-8	50	393.80

18-8 Stainless Steel



FINISHED HEX NUTS

Double Chamfered
Manufactured to ASME B18.2.2 dimensions

Part #	Size	Ctn Qty	Wght Lbs/M	Part #	Size	Ctn Qty	Wght Lbs/M
14NF188	1/4-20	5,000	7.20	51NF188	1/2-20	500	35.41
15NF188	1/4-28	5,000	7.00	62NF188	5/8-11	500	70.51
31NF188	5/16-18	3,000	10.00	75NF188	3/4-10	100	111.75
32NF188	5/16-24	3,000	10.20	87NF188	7/8-9	100	175.00
37NF188	3/8-16	2,000	15.20	100NF188	1-8	50	249.06
38NF188	3/8-24	2,000	15.00	112NF188	1 1/8-7	50	388.30
43NF188	7/16-14	1,000	27.34	125NF188	1 1/4-7	30	517.50
44NF188	7/16-20	500	27.00	137NF188	1 3/8-6	20	707.50
50NF188	1/2-13	500	36.24				

18-8 Stainless Steel



HEX JAM NUTS

Finished Pattern
Manufactured to ASME B18.2.2 dimensions

Part #	Size	Ctn Qty	Wght Lbs/M	Part #	Size	Ctn Qty	Wght Lbs/M
14NJ188	1/4-20	2,000	5.14	37NJ188	3/8-16	1,000	9.79
15NJ188	1/4-28	2,000	4.90	38NJ188	3/8-24	1,000	9.75
31NJ188	5/16-18	2,000	7.19	50NJ188	1/2-13	500	25.13
32NJ188	5/16-24	2,000	7.14	51NJ188	1/2-20	500	25.33

Black Oxide over
18-8 Stainless Steel

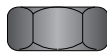

FINISHED HEX NUTS

Double Chamfered
Manufactured to ASME B18.2.2 dimensions

Part #	Size	Ctn Qty	Wght Lbs/M	Part #	Size	Ctn Qty	Wght Lbs/M
14NF188B	1/4-20	5,000	7.20	37NF188B	3/8-16	2,000	15.13
31NF188B	5/16-18	3,000	10.00	50NF188B	1/2-13	500	36.24

316 Stainless Steel



HEX MACHINE SCREW NUTS

Manufactured to ASME B18.2.2 dimensions

Part #	Size	Ctn Qty	Wght Lbs/M	Part #	Size	Ctn Qty	Wght Lbs/M
04NH316	4-40X1/4X3/32	5,000	1.08	10NH316	10-24X3/8X1/8	5,000	3.04
06NH316	6-32X5/16X7/64	5,000	2.07	11NH316	10-32X3/8X1/8	5,000	3.04
08NH316	8-32X11/32X1/8	5,000	2.64	14NH316	1/4-20X7/16X3/8	2,000	6.08

18-8 Stainless Steel



HEX MACHINE SCREW NUTS

Manufactured to ASME B18.2.2 dimensions

Part #	Size	Ctn Qty	Wght Lbs/M	Part #	Size	Ctn Qty	Wght Lbs/M
-0NH188	0-80X5/32X3/64	5,000	0.22	10NH188	10-24X3/8X1/8	5,000	2.90
02NH188	2-56X3/16X1/16	5,000	0.40	11NH188	10-32X3/8X1/8	5,000	2.88
03NH188	3-48X3/16X1/16	5,000	0.36	12NH188	12-24X7/16X5/32	2,500	5.17
04NH188	4-40X1/4X3/32	5,000	1.03	14NH188	1/4-20X7/16X3/8	2,000	6.01
06NH188	6-32X5/16X7/64	5,000	2.02	31NH188	5/16-18X9/16X7/8	1,500	11.82
08NH188	8-32X11/32X1/8	5,000	2.59				

Black Oxide over
18-8 Stainless Steel



HEX MACHINE SCREW NUTS

Manufactured to ASME B18.2.2 dimensions

Part #	Size	Ctn Qty	Wght Lbs/M	Part #	Size	Ctn Qty	Wght Lbs/M
04NH188B	4-40X1/4X3/32	5,000	1.06	10NH188B	10-24X3/8X1/8	5,000	3.10
06NH188B	6-32X5/16X7/64	5,000	2.08	11NH188B	10-32X3/8X1/8	5,000	2.88
08NH188B	8-32X11/32X1/8	5,000	2.50	14NH188B	1/4-20X7/16X3/8	2,000	6.01

18-8 Stainless Steel



HEX MACHINE SCREW NUTS

Small Pattern
Manufactured to ASME B18.2.2 dimensions

Part #	Size	Ctn Qty	Wght Lbs/M	Part #	Size	Ctn Qty	Wght Lbs/M
0403NH188	4-40X3/16X1/16	5,000	0.35	0805NH188	8-32X5/16X7/64	5,000	1.79
0504NH188	5-40X1/4X3/32	5,000	0.98	1005NH188	10-24X5/16X7/64	4,000	1.62
0604NH188	6-32X1/4X3/32	5,000	0.91	1105NH188	10-32X5/16X7/64	5,000	2.88

18-8 Stainless Steel

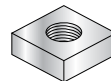

SQUARE MACHINE SCREW NUTS

Manufactured to ASME B18.2.2 dimensions

Part #	Size	Ctn Qty	Wght Lbs/M	Part #	Size	Ctn Qty	Wght Lbs/M
04NQ188	4-40	2,500	1.32	12NQ188	12-24	2,500	6.67
06NQ188	6-32	2,500	2.53	14NQ188	1/4-20	1,500	7.00
08NQ188	8-32	2,500	3.36	31NQ188	5/16-18	1,000	13.83
10NQ188	10-24	2,500	3.90	37NQ188	3/8-16	500	17.83
11NQ188	10-32	2,500	3.89				

18-8 Stainless Steel

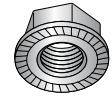

SERRATED HEX FLANGE LOCK NUTS

A corrosion-resistant nut with locking serrations

Part #	Size	Ctn Qty	Wght Lbs/M	Part #	Size	Ctn Qty	Wght Lbs/M
08NR188	8-32	2,000	5.00	31NR188	5/16-18	1,000	13.20
10NR188	10-24	2,000	6.09	37NR188	3/8-16	500	18.71
11NR188	10-32	2,000	6.23	50NR188	1/2-13	250	45.00
14NR188	1/4-20	1,000	8.72				

18-8 Stainless Steel

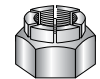

FLEX TYPE LOCK NUTS

Light Hex, Full Height

Part #	Size	Ctn Qty	Wght Lbs/M	Part #	Size	Ctn Qty	Wght Lbs/M
06NXL188	6-32	250	2.44	31NXL188	5/16-18	125	11.70
08NXL188	8-32	250	3.80	32NXL188	5/16-24	125	11.27
10NXL188	10-24	250	4.36	37NXL188	3/8-16	125	18.30
11NXL188	10-32	250	4.29	38NXL188	3/8-24	125	17.25
14NXL188	1/4-20	250	7.30	50NXL188	1/2-13	50	41.60
15NXL188	1/4-28	250	7.40	51NXL188	1/2-20	50	40.35

18-8 Stainless Steel

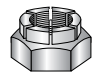

FLEX TYPE LOCK NUTS

Light Hex, Thin Height

Part #	Size	Ctn Qty	Wght Lbs/M	Part #	Size	Ctn Qty	Wght Lbs/M
06NXLTH188	6-32	250	1.87	31NXLTH188	5/16-18	125	8.40
08NXLTH188	8-32	250	3.00	32NXLTH188	5/16-24	125	8.37
10NXLTH188	10-24	250	3.36	37NXLTH188	3/8-16	125	10.90
11NXLTH188	10-32	250	3.32	38NXLTH188	3/8-24	125	10.67
14NXLTH188	1/4-20	250	5.44	50NXLTH188	1/2-13	50	22.90
15NXLTH188	1/4-28	250	5.48	51NXLTH188	1/2-20	50	22.15

Now Available:

**Square Weld Nuts to DIN 928 in
A2 Stainless—page 12.**



18-8 Stainless Steel



EXTERNAL LOCKWASHER
"K"-LOCK NUTS

Pre-Assembled Nut and Free Spinning External Tooth Washer

Part #	Size	Ctn Qty	Wght Lbs/M	Part #	Size	Ctn Qty	Wght Lbs/M
04NK188	4-40	2,000	1.20	11NK188	10-32	1,500	3.44
06NK188	6-32	2,000	2.21	14NK188	1/4-20	1,000	6.57
08NK188	8-32	2,000	2.88	31NK188	5/16-18	1,000	11.57
10NK188	10-24	2,000	3.45	37NK188	3/8-16	500	16.06

18-8 Stainless Steel



NYLON INSERT
STOP NUTS

Light Hex, Standard Height (NM & NE Series)
Manufactured to dimensions originally written by ESNA®

Part #	Size	Ctn Qty	Wght Lbs/M	Part #	Size	Ctn Qty	Wght Lbs/M
02NS188	2-56 NM	3,000	1.30	32NS188	5/16-24 NE	1,000	12.00
04NS188	4-40 NM	3,000	1.24	37NS188	3/8-16 NE	500	17.00
06NS188	6-32 NM	3,000	2.46	43NS188	7/16-14 NE	400	20.00
08NS188	8-32 NM	3,000	4.05	44NS188	7/16-20 NE	400	20.10
10NS188	10-24 NM	2,000	4.81	50NS188	1/2-13 NE	200	45.00
11NS188	10-32 NM	2,000	4.67	51NS188	1/2-20 NE	200	40.76
12NS188	12-24 NM	2,000	6.25	62NS188	5/8-11 NE	100	86.50
14NS188	1/4-20 NE	1,500	7.92	75NS188	3/4-10 NE	100	116.75
15NS188	1/4-28 NE	500	7.70	87NS188	7/8-9 NE	100	193.20
31NS188	5/16-18 NE	1,000	11.50				

Black Oxide over
18-8 Stainless Steel



EXTERNAL LOCKWASHER
"K"-LOCK NUTS

Pre-Assembled Nut and Free Spinning External Tooth Washer

Part #	Size	Ctn Qty	Wght Lbs/M	Part #	Size	Ctn Qty	Wght Lbs/M
04NK188B	4-40	2,000	1.24	10NK188B	10-24	2,000	3.44
06NK188B	6-32	2,000	2.25	11NK188B	10-32	1,500	3.40
08NK188B	8-32	2,000	2.88	14NK188B	1/4-20	1,000	6.83

Black Oxide over
18-8 Stainless Steel



NYLON INSERT
STOP NUTS

Light Hex, Standard Height (NM & NE Series)
Manufactured to dimensions originally written by ESNA®

Part #	Size	Ctn Qty	Wght Lbs/M	Part #	Size	Ctn Qty	Wght Lbs/M
04NS188B	4-40 NE	3,000	1.21	14NS188B	1/4-20 NE	1,500	7.75
06NS188B	6-32 NM	3,000	2.40	31NS188B	5/16-18 NE	1,000	10.67
08NS188B	8-32 NE	3,000	4.08	32NS188B	5/16-24 NE	1,000	10.50
10NS188B	10-24 NE	2,000	4.75	37NS188B	3/8-16 NE	500	17.42
11NS188B	10-32 NE	2,000	4.80				

18-8 Stainless Steel

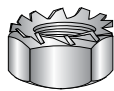

EXTERNAL LOCKWASHER
"K"-LOCK NUTS

Small Pattern

Pre-Assembled External Tooth Washer and Nut
Nuts have smaller Across the Flats dimensions than standard pattern nuts

Part #	Size	Ctn Qty	Wght Lbs/M	Part #	Size	Ctn Qty	Wght Lbs/M
0604NK188	6-32X1/4	2,000	1.08				

316 Stainless Steel



NYLON INSERT
STOP NUTS

Light Hex, Standard Height (NM & NE Series)
Manufactured to dimensions originally written by ESNA®

Part #	Size	Ctn Qty	Wght Lbs/M	Part #	Size	Ctn Qty	Wght Lbs/M
14NS316	1/4-20 NE	1,500	7.81	37NS316	3/8-16 NE	500	17.46
31NS316	5/16-18 NE	1,000	11.69	50NS316	1/2-13 NE	200	42.12

18-8 Stainless Steel



NYLON INSERT THIN PATTERN
STOP NUTS

Light Hex, Thin Height (NTM & NTE Series)
Manufactured to dimensions originally written by ESNA®

Part #	Size	Ctn Qty	Wght Lbs/M	Part #	Size	Ctn Qty	Wght Lbs/M
04NST188	4-40 NTM	2,000	0.83	31NST188	5/16-18 NTE	1,000	7.15
06NST188	6-32 NTM	2,000	1.65	37NST188	3/8-16 NTE	500	9.17
08NST188	8-32 NTM	3,000	2.70	50NST188	1/2-13 NTE	200	17.72
10NST188	10-24 NTM	3,000	3.30	62NST188	5/8-11 NTE	100	37.55
11NST188	10-32 NTM	3,000	3.36	76NST188	3/4-16 NTE	100	48.70
14NST188	1/4-20 NTE	1,000	4.50				

NEW!

DIN 985 Nylon Insert Stop Nuts

in A4 Stainless—

See page 12.



18-8 Stainless Steel



**FLAT STAINLESS
SPRING NUTS**

Also referred to as "Speed Nuts"
Manufactured from 18-8 Stainless Steel

Part #	Tinnerman® Part #	Ctn Qty	Wght Lbs/M	Part #	Tinnerman® Part #	Ctn Qty	Wght Lbs/M
145228	C105SS-440-4	5,000	0.35				

18-8 Stainless Steel

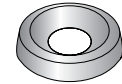

**COUNTERSUNK FINISHING
WASHERS**

To be used with Flat Head or Oval Head Screws

Part #	Size	Ctn Qty	Wght Lbs/M	Part #	Size	Ctn Qty	Wght Lbs/M
04WC188	4	10,000	0.49	12WC188	12	4,000	2.00
06WC188	6	10,000	0.80	14WC188	1/4	2,500	2.40
08WC188	8	10,000	1.00	31WC188	5/16	1,500	3.90
10WC188	10	8,000	1.50	37WC188	3/8	1,000	6.30

18-8 Stainless Steel,
Passivated & Waxed

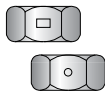

**TWO WAY REVERSIBLE
LOCK NUTS (COARSE THREAD)**

Finished Pattern
Can have 2 or 3 indentations on the flat sides of the nut equidistant from each other

Part #	Size	Ctn Qty	Wght Lbs/M	Part #	Size	Ctn Qty	Wght Lbs/M
14NY188	1/4-20	1,000	7.24	37NY188	3/8-16	500	15.50
31NY188	5/16-18	750	10.48	50NY188	1/2-13	200	35.08

18-8 Stainless Steel

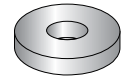

**STANDARD FLAT
WASHERS**

18-8 Stainless Steel

Part #	Size	Ctn Qty	Wght Lbs/M	Part #	Size	Ctn Qty	Wght Lbs/M
1410WF188	1/4X5/8X.05	5,000	2.70	4318WF188	7/16X1 1/8X.06	2,000	13.00
1412WF188	1/4X3/4X.05	1,000	3.00	5020WF188	1/2X1 1/4X.06	1,000	16.00
3110WF188	5/16X5/8X.05	1,000	4.00	6224WF188	5/8X1 1/2X.08	500	30.00
3112WF188	5/16X3/4X.05	5,000	4.36	7528WF188	3/4X1 3/4X.11	500	52.00
3114WF188	5/16X7/8X.05	1,000	5.20	8732WF188	7/8X2X.11	300	68.00
3116WF188	5/16X1X.05	1,000	6.40	10032WF188	1X2X.12	100	63.00
3712WF188	3/8X3/4X.05	1,000	4.05				
3714WF188	3/8X7/8X.05	3,000	6.15				
3716WF188	3/8X1X.05	2,000	8.50				

18-8 Stainless Steel



**COLD FORGED
WING NUTS**

Manufactured to ASME B18.17 dimensions

Part #	Size	Ctn Qty	Wght Lbs/M	Part #	Size	Ctn Qty	Wght Lbs/M
06NWC188	6-32	500	3.80	14NWC188	1/4-20	500	11.92
08NWC188	8-32	500	5.80	31NWC188	5/16-18	200	16.02
10NWC188	10-24	500	6.67	37NWC188	3/8-16	200	25.96
11NWC188	10-32	500	6.64	50NWC188	1/2-13	100	58.04

316 Stainless Steel



**STANDARD FLAT
WASHERS**

316 Stainless Steel

Part #	Size	Ctn Qty	Wght Lbs/M	Part #	Size	Ctn Qty	Wght Lbs/M
1410WF316	1/4X5/8X.04	5,000	3.09	6220WF316	5/8X1 1/4X.07	500	30.00
1411WF316	1/4X11/16X.04	5,000	4.10	6224WF316	5/8X1 1/2X.07	500	28.00
3112WF316	5/16X3/4X.04	5,000	4.36	7528WF316	3/4X1 3/4X.1	500	41.00
3714WF316	3/8X7/8X.04	3,000	6.00	8732WF316	7/8X2X.1	300	64.00
3716WF316	3/8X1X.04	2,000	8.50	8736WF316	7/8X2 1/4X.1	100	90.00
5020WF316	1/2X1 1/4X.06	1,000	16.00	10032WF316	1X2X.12	100	61.25
				10040WF316	1X2 1/2X.12	100	110.21

