

DESCRIPTION/APPLICATION

The Thomas & Betts LSA/LSG series connector and adapter offer superior performance in a compact, durable design that is compatible with other designed connectors.

The LSA connector is made of all stainless alloy hardware and is provided with a zirconia ceramic ferrule. The ferrule is spring-loaded and is isolated from the effects of cable movement.

Also available is the LSG interconnect which has a free floating zirconia ceramic split alignment sleeve incorporated into an all stainless alloy body.

LSA series connectors may be used with a variety of cable sizes. They may be ordered factory terminated with standard return losses -45 dB or better, or as high as -70 dB with APC. The average insertion loss is < 0.2 dB.

DESIGN ADVANTAGES

- DIN47256-compatible
- Compact design
- Low insertion loss, < 0.2 dB average
- Highly repeatable
- Cable side-loading of 5 Newtons (1.1 lbs.) results in less than 0.1 dB change in attenuation
- Cable pull of 30 Newtons (6.6 lbs.) results in no change in insertion loss
- Approved by FTZ (Deutsche Telekom)

(Ref: Connector—DT2E; Interconnect—DT4E)

- Meets CECC 86135-801, CECC 86135-802,

CECC 86285-801 and CECC 86285-802 specifications

GB SERIES LSA/LSG CONNECTOR SYSTEM

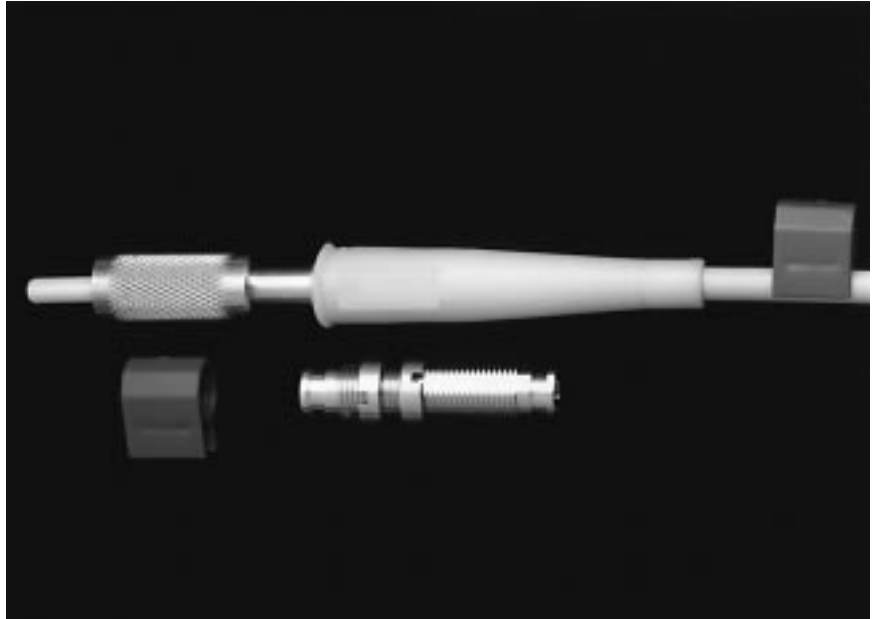

A high-performance LSA/LSG compatible connector system developed under the guidelines of the Deutsche Telekom.

GB SERIES LSA/LSG CONNECTOR SYSTEM

SPECIFICATIONS — CONNECTOR

INSERTION LOSS: < 0.2 dB

RETURN LOSS: < -45 dB

PHYSICAL PROPERTIES

FERRULE: Zirconia Ceramic

Body: Nickel Silver

Nut: Nickel Silver

SPECIFICATIONS — INTERCONNECT

INSERTION LOSS: < 0.2 dB (when mated with referenced connections)

PHYSICAL PROPERTIES

SPLIT SLEEVE: Zirconia Ceramic

Body: Nickel Silver

Nut: Nickel Silver

RETAINING RING: Nickel Silver

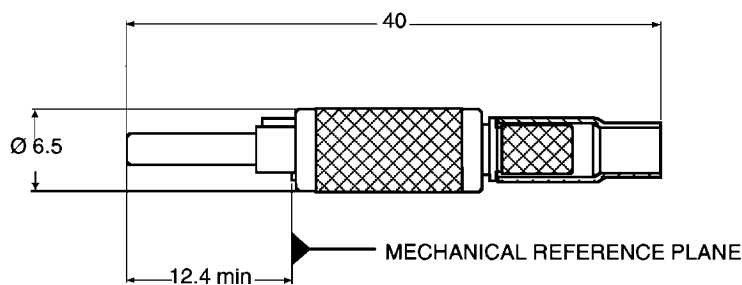
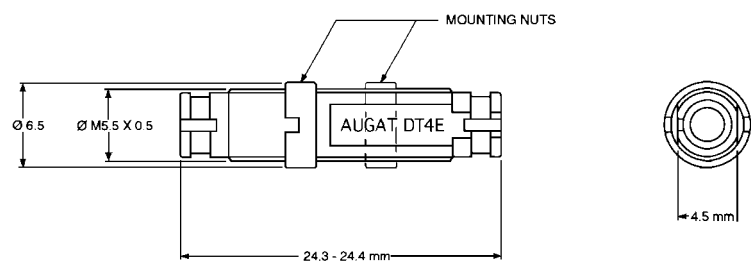

Cat. No.	Description
60000-200-01	Interconnect
60000-300-01	Connector

DESCRIPTION/APPLICATION

Thomas & Betts Plastic Fiber Optic Cable consists of a PMMA core, polymer clad with a durable black polyethylene jacket. It is available in 100 and 500 foot lengths in both simplex and duplex zipcord styles.* The cable is compatible with a complete line of Thomas & Betts connector products which include: the Thomas & Betts PCB Data Link System, Active duplex Connector, Bulkhead Connector, RS-232-C Modem and Splice Kit.

DESIGN CONSIDERATIONS

- Low-profile, lightweight.
- Perfect for sub 130 meter applications.
- No polishing.
- Compatible with Thomas & Betts self-termination technology.
- Low bend radius (approximately 1-inch).
- High strain relief.
- Wide temperature range (-35°C to +80°C).
- Low-cost.
- No installation tooling necessary.
- 1mm plastic fiber.

PLASTIC FIBER OPTIC CABLE

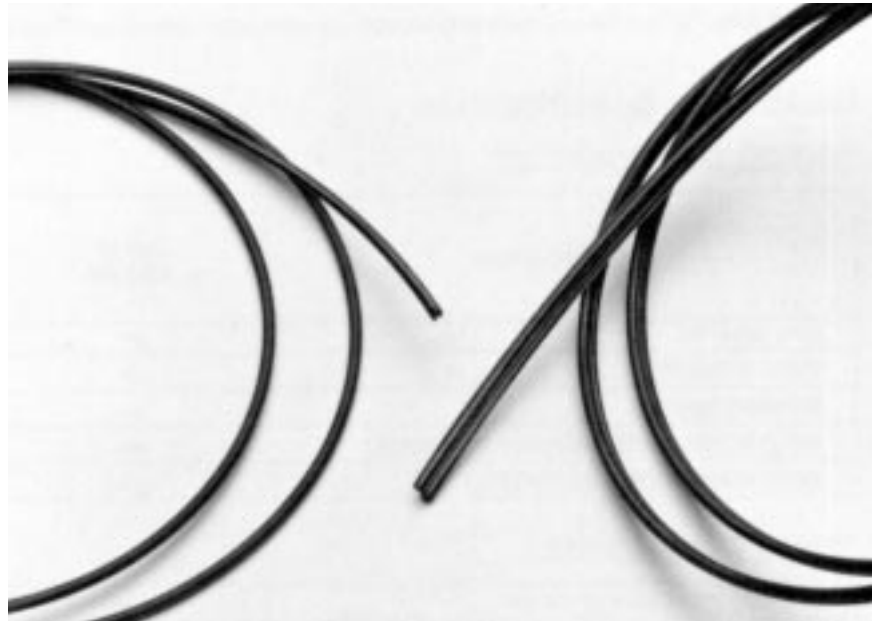

Low profile, lightweight, plastic fiber optic cable

Ordering Information

PART NUMBER	DESCRIPTION
93902-100	100" Simplex Optical Cable
93902-500	500" Simplex Optical Cable
93802-100	100" Roll Duplex Plastic Fiber Cable
93802-500	500" Roll Duplex Plastic Fiber Cable

