

.695" HEIGHT PROFILE METAL SHELL PRESS FIT FEMALE RECEPTACLES FOR PCB MOUNTING



PHYSICAL PROPERTIES

INSULATION MATERIAL: Glass filled polyester rated UL 94V-0
COLOR: Black
CONTACTS: High strength copper alloy
METAL SHELL: Steel, bright tin plate
DURABILITY: Up to 300 insertions and withdrawals without degradation of performance, dependent upon contact plating thickness selected

ELECTRICAL PROPERTIES

OPERATING VOLTAGE: 600 VDC (sea level)
CURRENT RATING: 5 Amperes
CONTACT RESISTANCE: 10 milliohms max. @ rated current
INSULATION RESISTANCE: 5000 megohms minimum
DIELECTRIC WITHSTANDING VOLTAGE: 1000 VAC minimum

ENVIRONMENTAL PROPERTIES

TEMPERATURE RATING: -55°C TO 125°C

APPLICATION TOOLING

Mass Insertion Press Fit Tool:

- 09 pos. 9823501
- 15 pos. 9823502
- 25 pos. 9823503
- 37 pos. 9823504

REMOVAL TOOL: Part # 98180

CAP REMOVAL TOOL: Part # 98175

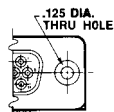
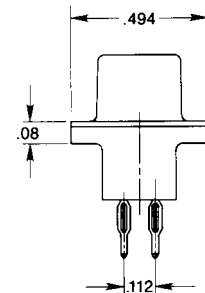
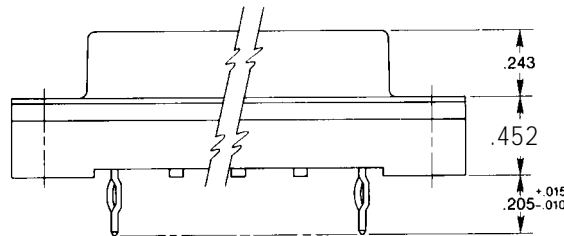
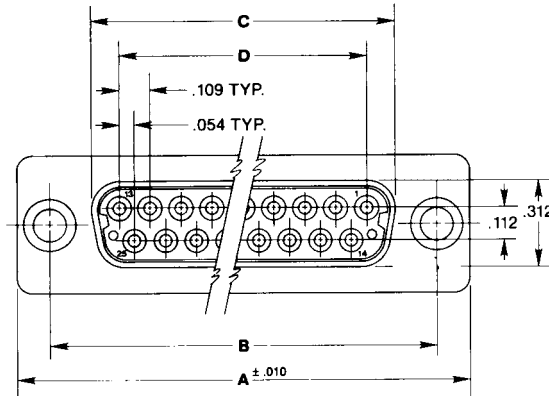

MOUNTING STYLE A
FLUSH

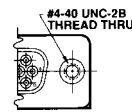

MOUNTING STYLE B
THREADED STANDOFF

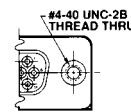

MOUNTING STYLE C
FLUSH INSERT

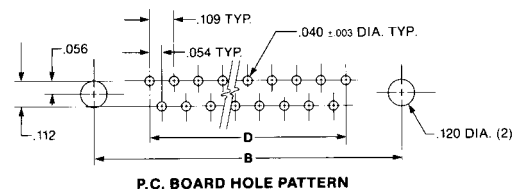

Ordering Information

NUMBER OF CONTACTS	BASIC CONNECTOR W/ .120" DIA. THRU HOLES	CATALOG NUMBER BY MOUNTING STYLE		DIMENSIONS			
		4-40 THREADED STANDOFF	4-40 FLUSH THREADED INSERT	A	B	C	D
9	H9R09PF29A	H9R09PF29B	H9R09PF29C	1.224	.984	.646	.436
15	H9R15PF29A	H9R15PF29B	H9R15PF29C	1.552	1.312	.974	.763
25	H9R25PF29A	H9R25PF29B	H9R25PF29C	2.092	1.852	1.514	1.308
37	H9R37PF29A	H9R37PF29B	H9R37PF29C	2.740	2.500	2.162	1.962

NOTE: Add suffix S for metal snap latch. Not available on basic connector.

DESCRIPTION/APPLICATION

Our crimp snap-in contacts product allows for easy assembly of D-Sub miniature cable connectors. Crimp wire termination can be done with automatic or manual tools. Contacts can be hand inserted into the insulator housing for fast reliable connector assembly.

DESIGN ADVANTAGES

- Available in all standard contact configurations including 9, 15, 25, 37 and 50.
- Designed to comply with most industry interface standards, such as EIA-RS-232C and EIA RS-449.
- Complete line of mounting and locking hardware types.
- Application tooling available.
- Stamped and formed contacts available in both reeled and loose-piece form, along with several plating options.
- Rear release snap-in contact design provides maximum field service economy.
- Bright tin plate with grounding indents provide high reliability shielding interface.

D-SUB CRIMP - SNAP CONNECTORS

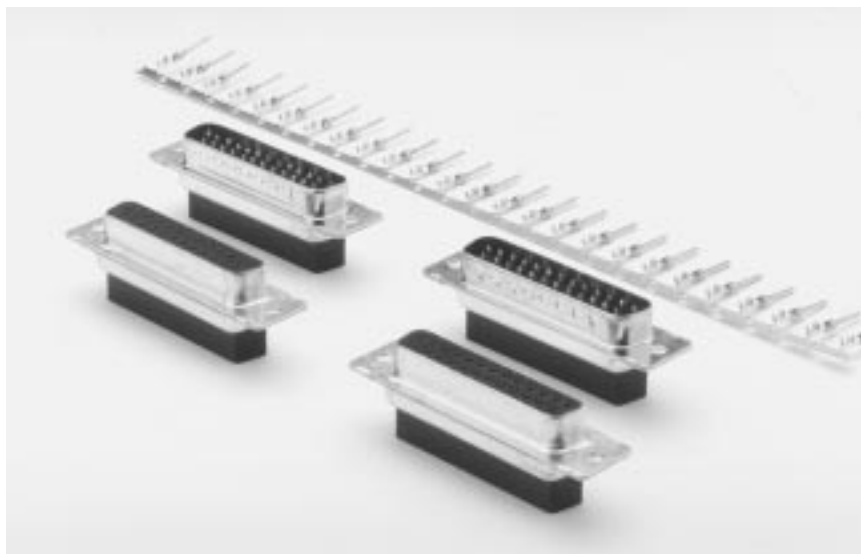

CRIMP AND SNAP-IN MALE CONNECTOR HOUSINGS



PHYSICAL PROPERTIES

INSULATION MATERIAL: Thermoplastic rated UL 94V-0

COLOR: Black

METAL SHELL: Steel, bright tin plate

ELECTRICAL PROPERTIES

CURRENT RATING: 7.5 Amperes max.

CONTACT RESISTANCE: 5 milliohms max. initial, 10 milliohms max. after environmental testing

DIELECTRIC WITHSTANDING VOLTAGE:

1000 VAC minimum

WIRE RANGE: #24-20 AWG and #28-24 AWG

ENVIRONMENTAL PROPERTIES

TEMPERATURE RATING: -55°C TO 105°C

CONTACTS

See page 331

APPLICATION TOOLING

HAND CRIMP TOOL: 600112

See page 332 for application tooling

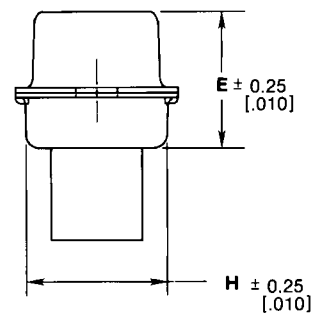
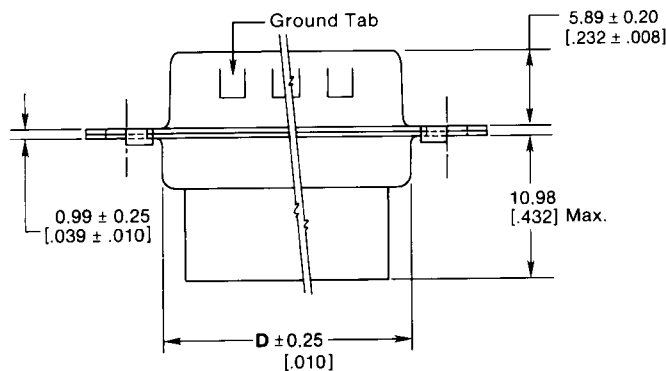
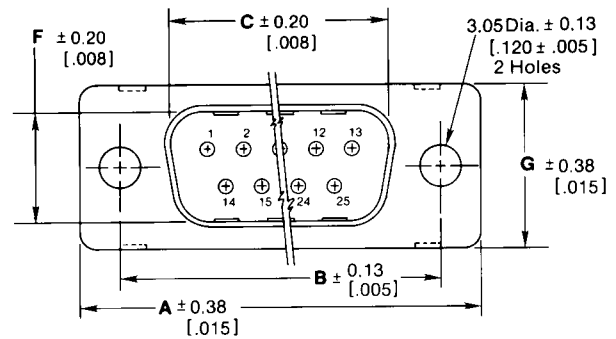

Ordering Information

NO. OF POS.	CATALOG NUMBER BRIGHT TIN WITH INDENTS	MALE CONNECTOR DIMENSIONS							
		A	B	C	D	E	F	G	H
9	HM09A	30.81 (1.213)	24.99 (.984)	16.92 (.666)	19.28 (.759)	10.72 (.422)	8.36 (.329)	12.55 (.494)	10.87 (.428)
15	HM15A	39.14 (1.541)	33.32 (1.312)	25.25 (.994)	27.51 (1.083)	10.72 (.422)	8.36 (.329)	12.55 (.494)	10.87 (.428)
25	HM25A	53.04 (2.088)	47.04 (1.852)	38.96 (1.534)	41.40 (1.630)	10.82 (.426)	8.36 (.329)	12.55 (.494)	10.87 (.428)
37	HM37A	69.32 (2.729)	63.50 (2.500)	55.42 (2.182)	57.71 (2.272)	10.82 (.426)	8.36 (.329)	12.55 (.494)	10.87 (.428)
50	HM50A	66.93 (2.635)	61.11 (2.406)	52.81 (2.079)	55.32 (2.178)	10.82 (.426)	11.07 (.436)	15.37 (.605)	13.51 (.532)

CRIMP AND SNAP-IN FEMALE CONNECTOR HOUSINGS



PHYSICAL PROPERTIES

INSULATION MATERIAL: Thermoplastic
rated UL 94V-0

COLOR: Black

METAL SHELL: Steel, bright tin plate

ELECTRICAL PROPERTIES

CURRENT RATING: 7.5 Amperes max.

CONTACT RESISTANCE: 5 milliohms max. initial,
10 milliohms max. after environmental testing

DIELECTRIC WITHSTANDING VOLTAGE:

1000 VAC minimum

WIRE RANGE: #24-20 AWG and #28-24 AWG

ENVIRONMENTAL PROPERTIES

TEMPERATURE RATING: -55°C TO 105°C

CONTACTS

See page 331

APPLICATION TOOLING

HAND CRIMP TOOL: 600112

See page 332 for application tooling

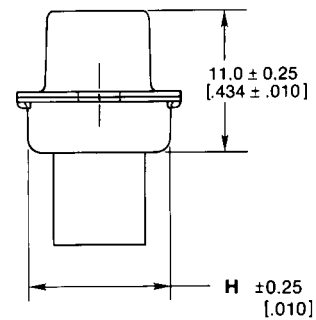
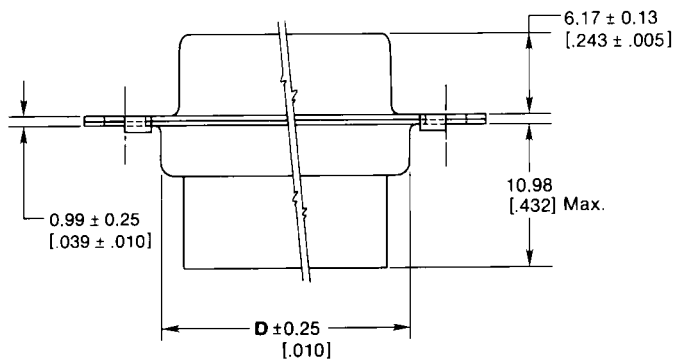
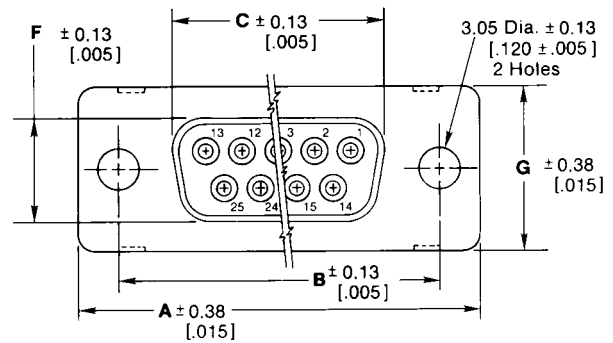

Ordering Information

NO. OF POS.	CATALOG NUMBER BRIGHT TIN W/O INDENTS	FEMALE CONNECTOR DIMENSIONS							
		A	B	C	D	E	F	G	H
9	HR09B	30.81 (1.213)	24.99 (.984)	16.92 (.666)	19.28 (.759)	10.72 (.422)	8.36 (.329)	12.55 (.494)	10.87 (.428)
15	HR15B	39.14 (1.541)	33.32 (1.312)	25.25 (.994)	27.51 (1.083)	10.72 (.422)	8.36 (.329)	12.55 (.494)	10.87 (.428)
25	HR25B	53.04 (2.088)	47.04 (1.852)	38.96 (1.534)	41.40 (1.630)	10.82 (.426)	8.36 (.329)	12.55 (.494)	10.87 (.428)
37	HR37B	69.32 (2.729)	63.50 (2.500)	55.42 (2.182)	57.71 (2.272)	10.82 (.426)	8.36 (.329)	12.55 (.494)	10.87 (.428)
50	HR50B	66.93 (2.635)	61.11 (2.406)	52.81 (2.079)	55.32 (2.178)	10.82 (.426)	11.07 (.436)	15.37 (.605)	13.51 (.532)