

**2,5MM SURFACE MOUNT TECHNOLOGY
WITH WIRE TRAP
SERIES SMC**

PHYSICAL PROPERTIES

Housing:

HOUSING MATERIAL: Polyphenylene Sulfide (PPS)

FLAMMABILITY: UL94V-0

COLOR: Beige

Terminal:

CONTACT: Phosphor bronze, tin plated over nickel

Mechanical:

PITCH (TERMINAL SPACING): 2,5mm

WIRE STRIP LENGTH: 0.22" min, 0.28" max

MAX. WIRE INSULATION DIAMETER: 1.7mm

PACKAGING: Tape and reel

ELECTRICAL PROPERTIES:

MAXIMUM CURRENT: 3A

OPERATING VOLTAGE: 250V

WIRE RANGE: 24 AWG

DIELECTRIC WITHSTAND: 1500 VAC

ENVIRONMENTAL PROPERTIES:

MAX. OPERATING TEMPERATURE: 105° C

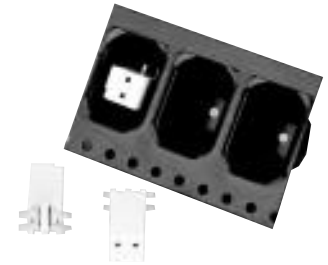

2,5mm Pitch

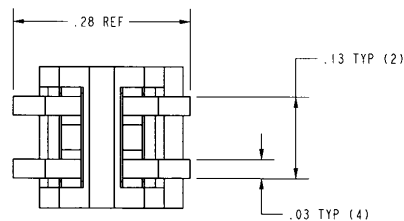
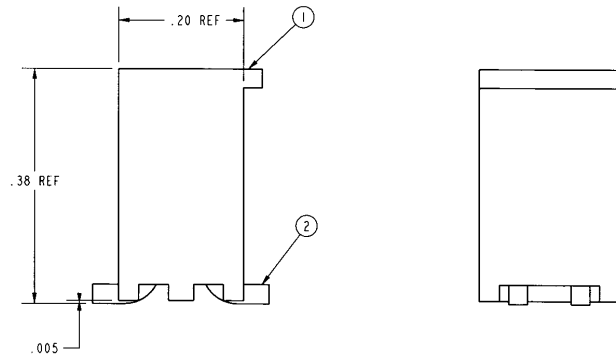
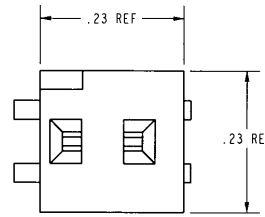

Ordering Information

# OF TERMINALS	CATALOG NUMBER	DESCRIPTION
2	SMC2402	Tape & Reel, 500 pieces
2	SM2V02	25 pieces