

Industrial Applications Heavy-Duty Slides



Heavy-Duty Slides

With loads ranging from 175 to 1,323 pounds, this group of slides provides strength and durability for a variety of heavy duty industrial applications. Lock-in, lock-out, and front lever release are some of the notable special features.

Specifications at a Glance

Model	Max. Load Capacity	Travel	Cross Section	Detent or Lock	Disconnect	Page
301	175 lbs. [80 kg]	Over	.75" [19.1 mm]	None	None	20
3601	255 lbs. [116 kg]	Over	.75" [19.1 mm]	Hold-in	None	20
3600	273 lbs. [124 kg]	Full	.75" [19.1 mm]	Hold-in	None	21
3607	273 lbs. [124 kg]	Full	.75" [19.1 mm]	Lock-out	Lever	21
3641	180 lbs. [82 kg]	Over	.89" [22.6 mm]	Hold-in	Rail	22
3657	273 lbs. [124 kg]	Full	.75" [19.1]	None	Lever	22
7950	350 lbs. [159 kg]	Full	.75" [19.1 mm]	Hold-in	None	23
7957	350 lbs. [159 kg]	Full	.75" [19.1 mm]	Hold-in	Lever	23
9301	500 lbs. [227 kg]	Full	.75" [19.1 mm]	Hold-in	None	24
9307	500 lbs. [227 kg]	Full	.75" [19.1 mm]	Lock-out	None	25
9308	500 lbs. [227 kg]	Full	.75" [19.1 mm]	Lock-in/Lock-out	None	25
AL4120	1,212 lbs. [550 kg]	3/4	1.42" [36 mm]	None	None	26
AL4140	1,323 lbs. [600 kg]	Full	1.50" [38 mm]	None	None	26

Industrial Applications

Heavy-Duty Slides



301

Low profile and over travel provide access in electronic enclosures, medical equipment and electromechanical devices.

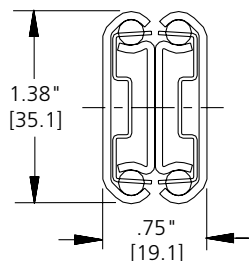

- Load capacity up to 175 lbs. [80 kg]/pair
- .88" [22.4 mm] over travel
- .75" [19.1 mm] side space
- Non-disconnect
- Even lengths 12"–28" [305–711 mm]
- Optional enclosure bracket mounting kit: P/N 4180-0222-XE

Slide Length	Slide Travel	Load Rating Lbs./Pr.
12.00 [305]	12.88 [327]	175 [80]
14.00 [356]	14.88 [378]	170 [77]
16.00 [406]	16.88 [429]	160 [73]
18.00 [457]	18.88 [480]	150 [68]
20.00 [508]	20.88 [530]	142 [65]
22.00 [559]	22.88 [581]	130 [59]
24.00 [610]	24.88 [632]	115 [52]
26.00 [660]	26.88 [683]	105 [48]
28.00 [711]	28.88 [734]	90 [41]



3601

Over travel and heavy-duty capacity make this slide a popular choice for utility and industrial truck bodies, machine tools and mechanical devices.

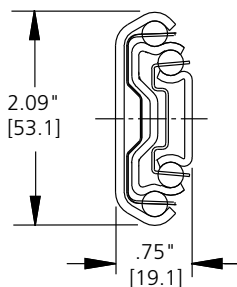

- Load capacity up to 255 lbs. [116 kg]/pair
- 1" [25.4 mm] over travel
- .75" [19.1mm] side space
- Non-disconnect
- Hold-in detent
- Even lengths 12"–28" [305–711 mm]
- Optional enclosure bracket mounting kit: P/N 4180-0220-XE

Slide Length	Slide Travel	Load Rating Lbs./Pr.
12.00 [305]	13.00 [330]	255 [116]
14.00 [356]	15.00 [381]	248 [112]
16.00 [406]	17.00 [432]	241 [109]
18.00 [457]	19.00 [483]	234 [106]
20.00 [508]	21.00 [533]	225 [102]
22.00 [559]	23.00 [584]	215 [98]
24.00 [610]	25.00 [635]	203 [92]
26.00 [660]	27.00 [686]	188 [85]
28.00 [711]	29.00 [737]	169 [77]

Industrial Applications Heavy-Duty Slides

Slide Length	Slide Travel	Load Rating Lbs./Pr.
12.00	12.00	273
[305]	[305]	[124]
14.00	14.00	267
[356]	[356]	[121]
16.00	16.00	261
[406]	[406]	[118]
18.00	18.00	253
[457]	[457]	[115]
20.00	20.00	244
[508]	[508]	[111]
22.00	22.00	233
[559]	[559]	[106]
24.00	24.00	220
[610]	[610]	[100]
26.00	26.00	203
[660]	[660]	[92]
28.00	28.00	182
[711]	[711]	[83]



3600

Full extension and the higher load rating perform well in industrial workstations, machinery, and mechanical devices.

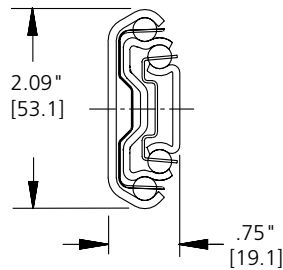

- Load capacity up to 273 lbs. [124 kg]/pair
- Full extension
- .75" [19.1 mm] side space
- Non-disconnect
- Hold-in detent
- Even lengths 12"–28" [305–711 mm]

Slide Length	Slide Travel	Load Rating Lbs./Pr.
12.00	12.00	273
[305]	[305]	[124]
14.00	14.00	267
[356]	[356]	[121]
16.00	16.00	261
[406]	[406]	[119]
18.00	18.00	253
[457]	[457]	[115]
20.00	20.00	244
[508]	[508]	[111]
22.00	22.00	233
[559]	[559]	[106]
24.00	24.00	220
[610]	[610]	[100]
26.00	26.00	203
[660]	[660]	[92]
28.00	28.00	182
[711]	[711]	[83]



3607

Lock-out and lever disconnect are useful in applications such as machinery or electronic chassis where components may require service.

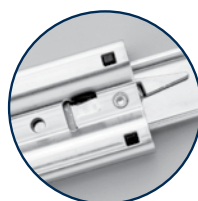

Lever Disconnect

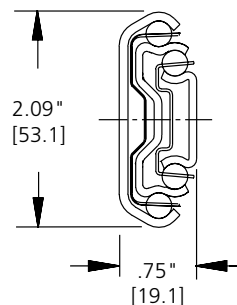

- Load capacity up to 273 lbs. [124 kg]/pair
- Full extension
- .75" [19.1 mm] side space
- Lever disconnect
- Lock-out
- Optional enclosure mounting brackets available
- Even lengths 12"–28" [305–711 mm]

Industrial Applications Heavy-Duty Slides



www.embertonmachine.com

New! 3657

Provides solutions for applications such as bulk storage bins, trays, or pullout shelving units in environments ranging from garages to game rooms to grocery stores.

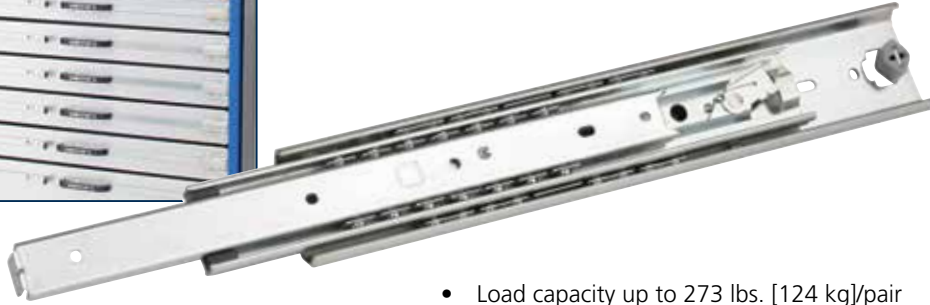

Slide Length	Slide Travel
12.00 [305]	12.00 [305]
14.00 [356]	14.00 [356]
16.00 [406]	16.00 [406]
18.00 [457]	18.00 [457]
20.00 [508]	20.00 [508]
22.00 [559]	22.00 [559]
24.00 [610]	24.00 [610]
26.00 [660]	26.00 [660]
28.00 [711]	28.00 [711]

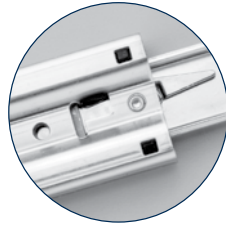
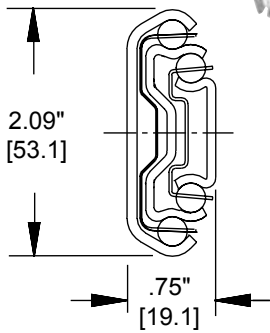

Lever Disconnect

- Load capacity up to 273 lbs. [124 kg]/pair
- Full extension
- .75" [19.1 mm] side space
- Lever disconnect
- Even lengths 12"-28" [305-722 mm]



3641

Designed with an interlock system to prevent more than one drawer from opening at a time. Ideal for heavy multi-drawer applications where tipping might occur due to weight shift.

Slide Length	Slide Travel
13.90 [353]	14.00 [356]
15.90 [404]	17.00 [432]
16.90 [429]	18.00 [457]
17.90 [455]	19.00 [483]
19.90 [505]	21.00 [533]
21.90 [556]	23.00 [584]
23.90 [607]	25.00 [635]
25.90 [658]	27.00 [686]
27.90 [709]	29.00 [737]

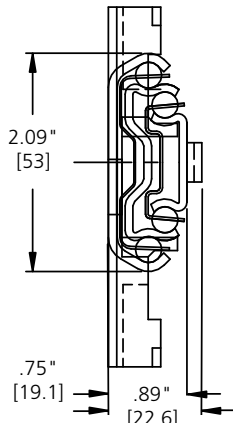

- Load capacity up to 180 lbs. [82 kg]/pair
- 1" [25.4 mm] over travel
- .89" [22.6 mm] side space
- Drawers up to 42" [1067 mm] wide
- One piece rail-and-pocket mount/disconnect system
- Front location of interlock eliminates reaching during installation
- Interfaces with central locking system
- Cut-to-length aluminum connecting rods
- Hold-in detent
- Even lengths 14"-28" and 17" [353-709 and 429 mm]



Industrial Applications Heavy-Duty Slides

Slide Length	Slide Travel
12.00	12.00
[305]	[305]
14.00	14.00
[356]	[356]
16.00	16.00
[406]	[406]
18.00	18.00
[457]	[457]
20.00	20.00
[508]	[508]
22.00	22.00
[559]	[559]
24.00	24.00
[610]	[610]
26.00	26.00
[660]	[660]
28.00	28.00
[711]	[711]
30.00	30.00
[762]	[762]
32.00	32.00
[813]	[813]
34.00	34.00
[864]	[864]
36.00	36.00
[914]	[914]



7950/7957

These products provide an intermediate load rating choice in a .75" cross section width. Designed to accommodate drawers up to 42" wide.



- May be side or flat mounted:
 - Side mount load capacity up to 350 lbs. [159 kg]/pair
 - Flat mount load capacity up to 150 lbs. [68 kg]/pair
- Full extension
- .75" [19.1 mm] side space
- 7950: non-disconnect
7957: handed lever disconnect
- Bridged ball retainer design prevents retainer migration.
- Even lengths 12"–36" [305–914 mm]

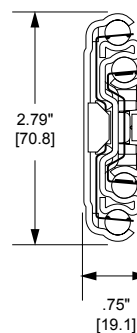

7950
Non-Disconnect

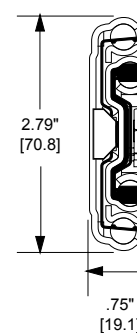

7957
Handed
Lever
Disconnect

NOTE: Available by special order: Models 7937 (lever disconnect) and 7930 (non-disconnect), which offer the same features in a narrower cross section width of .724" [18.4 mm].

Industrial Applications

Heavy-Duty Slides



9301

Offering heavy duty support in a variety of industrial storage applications. Optional platform brackets expand mounting options.

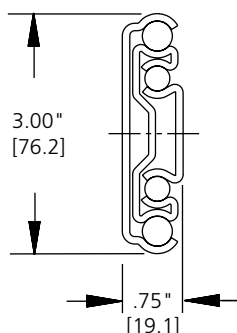
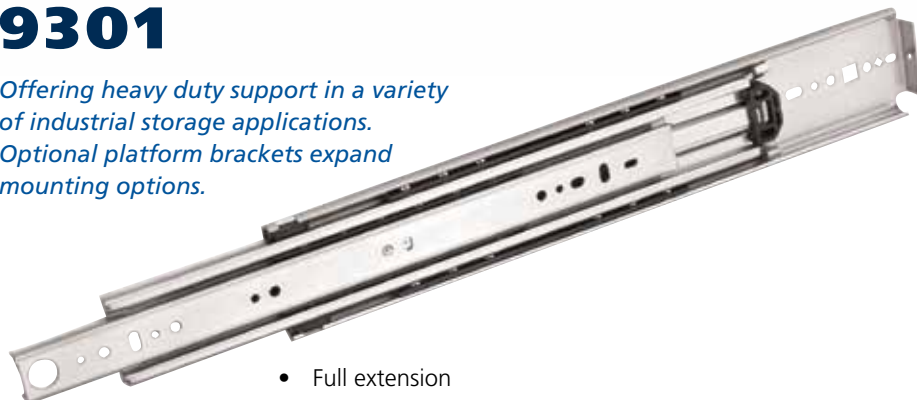

- Full extension
- .75" [19.1 mm] side space
- Silenced movement
- Non-disconnect
- Available in even lengths 10"–36", 40", 42", 44", 48", 60" [254–914 mm, 1016 mm, 1066 mm, 1118 mm, 1219 mm, 1524 mm]

Load Ratings/pair

- Flat mount: 150 lb. [68 kg]*
Drawer widths up to 32" [813 mm]
- Mobile applications: 300 lb. [136 kg]*
Drawer widths up to 32" [813 mm]
- Frequent usage: 400 lb. [181 kg]
Drawer widths up to 42" [1067 mm]
- Moderate usage: 500 lb. [227 kg]*
Drawer widths up to 18" [457 mm]
- Bracket-mounted: 350 lb. [159 kg]
Drawer widths up to 42" [1067 mm]
- Bracket-mounted: 500 lb. [227 kg]
Drawer widths up to 18" [457 mm]

Note: Special packaging is available which includes one standard 9301 and one right-hand 9308. Available lengths: 14"–32", 36", 40", 48", and 60". The part number for this packaging is 9308-5.

Platform Brackets

For use with Models 9301, 9307, and 9308

- Provides 6 additional mounting configurations
- Available in lengths of 12", 16", 22", and 28" [305 mm, 406 mm, 559 mm, 711 mm]
- Four bracket lengths have been designed to be used individually or combined to accommodate all slide lengths
- See technical sheet for ordering information.

SIDE MOUNT APPLICATIONS

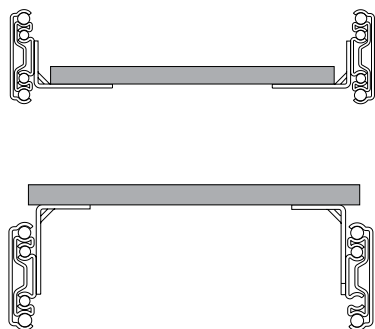

BOTTOM MOUNT APPLICATIONS

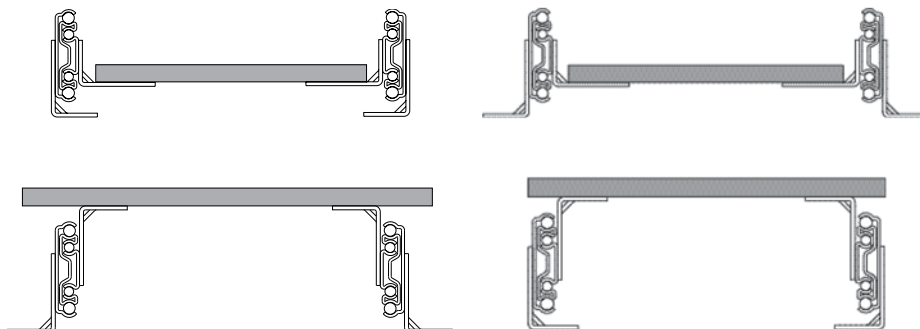

* For lengths 10"–36" [254–914 mm]. Consult Accuride for load ratings for longer



Industrial Applications Heavy-Duty Slides



Model 9308

9307 Lock-out

Heavy duty with a lock-out for applications where secure access to equipment drawers and trays is required.

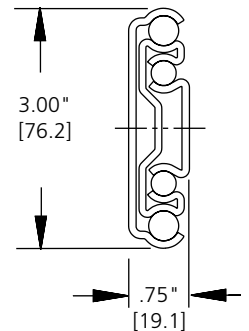

9308 Lock-in & Lock-out

Lock-in and lock-out features to ensure drawers stay securely closed during transit in applications such as emergency or hazmat vehicles.

Load Ratings/pair

Mobile applications:

300 lbs. [136 kg]*
Drawer widths up to
32" [813 mm]

Frequent usage:

400 lbs. [181 kg]**
Drawer widths up to
42" [1067 mm]

Moderate usage:

500 lbs. [227 kg]*
Drawer widths up to
18" [457 mm]

* Load ratings based on 10,000 cycle test

** Load rating based on 50,000 cycle test

Common Features

- Full extension
- .75" [19.1 mm] side space
- Non-disconnect
- Lock-in/Lock-out actuated with latch at front of slide
- Compatible with optional platform brackets (see page 24)
- For locking on one side only, order non-locking companion slide Model 9301
- Available in even lengths
12"-36", 40", 42", 48", 60"
[305-914 mm, 1016 mm,
1066 mm, 1219 mm, 1524 mm]

Note: Special packaging is available which includes one standard 9301 and one right-hand 9308. Available lengths: 14"-32", 36", 40", 48", and 60". The part number for this packaging is 9308-5.



Industrial Applications

Heavy-Duty Slides



Super Heavy-Duty Slides

Lightweight aluminum combined with stainless steel ball bearings and ball retainers provides corrosion resistance and strength without the additional weight of steel slides.

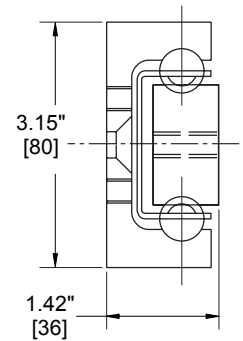

AL4120

- 3/4 extension
- 1.42" [36 mm] side space
- Load rating up to 1,212 lbs. [550 kg]/pair

AL4140

- Full extension
- 1.5" [38 mm] side space
- Load rating up to 1,323 lbs. [600 kg]/pair

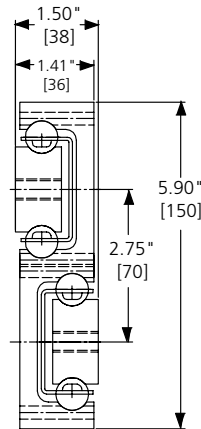

Common Features

- Load rating based on a pair of slides spaced 24" [610 mm] apart and tested to 5,000 cycles.
- Non-disconnect
- Stainless steel ball bearings
- Lengths: 16", 20", 24", 28", 32", 36", 40", 44" and 48" [400 mm, 500 mm, 600 mm, 700 mm, 800 mm, 900 mm, 1000 mm, 1100 mm, 1200 mm]*

* The lengths indicated in inches are approximate conversions from the metric measurements. Please see the chart at left or the product technical sheet for exact dimensions.

AL4140		AL4120	
Slide Length	Slide Travel	Slide Length	Slide Travel
15.75 [400]	15.82 [402]	15.75 [400]	11.42 [290]
19.69 [500]	21.38 [543]	19.69 [500]	14.17 [360]
23.62 [600]	24.60 [625]	23.62 [600]	16.93 [430]
27.56 [700]	27.83 [707]	27.56 [700]	19.72 [501]
31.50 [800]	33.39 [848]	31.50 [800]	22.52 [572]
35.43 [900]	36.61 [930]	35.43 [900]	25.28 [642]
39.37 [1000]	39.84 [1012]	39.37 [1000]	28.07 [713]
43.31 [1100]	30.83 [783]	43.31 [1100]	30.83 [783]
47.24 [1200]	35.58 [853]	47.24 [1200]	35.58 [853]

