

*Available in other materials. See material list in index.
Other sizes available on request.

HIGH TECHNOLOGY PLASTIC THUMB SCREWS

*Available in the following materials:

Material Code No.	Material Name	Material Code No.	Material Name	Material Code No.	Material Name	Material Code No.	Material Name
-3	Lexan®, (clear)	-28	CPVC	-60	Nylon 6/6, 30% Short Glass-filled	-213	VespeI®
-4	Lexan®, (black)	-29	Teflon®	-64	Delrin®, 25% Short Glass-filled	-218	Ryton, 40% Glass-filled, (black), (PPS)
-5	Ultem® 1000	-30	Tefzel®	-74	Isoplast™, 40% Long Glass Fiber, (natural)	-272	PVC, (white)
-6	Ultem® 2300, (black)	-32	PCTFE	-77	Ultem® 2300, (natural)	-273	PVC, (black)
-11	Polypropylene	-33	Polysulfone	-78	Noryl®	-226	Radel® A200, Polyethersulfone
-13	Polyethylene	-35	Noryl®	-194	Nylon 46, 30% Glass-filled, Heat Stabilized	-228	Radel® AG330, 30% Glass-filled
-14	ABS	-37	Kynar®, (PVDF)	-195	Nylon 46, 30% Glass-filled, Flame Retardant, Heat Stabilized	-229	Radel® R5000, Polyphenylsulfone
-15	PEEK®	-38	Fiber Glass G10				
-18	Nylon 6/6, (natural)	-39	UHMW®				
-23	Nylon Super Tough	-40	PFA, (Teflon®)				
-24	Delrin®, (white)	-41	Halar®				
-27	PVC						

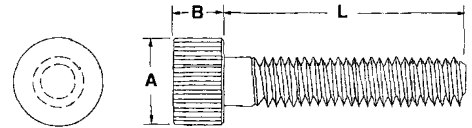

Part No. Q104 - (Size Code No.) - (Material Code No.)

Size Code No.	Thread Size	Length	Size Code No.	Thread Size	Length	Size Code No.	Thread Size	Length	Size Code No.	Thread Size	Length	Size Code No.	Thread Size	Length	Thread Size	A	B
-1	2-56	1/4	-59	6-32	7/8	-117	1/4-20	3/8	-175	5/16-24	2	-233	1/2-13	1-1/4	2-56	.250	.250
-2		5/16	-60		1	-118		7/16	-176		2-1/4	-234		1-1/2	3-48	.250	.250
-3		3/8	-61		1-1/8	-119		1/2	-177		2-1/2	-235		1-3/4	4-40	.312	.250
-4		7/16	-62		1-1/4	-120		9/16	-178		3	-236		2	4-48	.312	.312
-5		1/2	-63		1-1/2	-121		5/8	-179	3/8-16	1/2	-237		2-1/2	5-40	.312	.312
-6		9/16	-64	6-40	1/4	-122		3/4	-180		9/16	-238		3	6-32	.375	.312
-7		5/8	-65		5/16	-123		7/8	-181		5/8	-239	1/2-20	3/4	6-40	.375	.312
-8		3/4	-66		3/8	-124		1	-182		3/4	-240		1	8-32	.431	.312
-9		7/8	-67		7/16	-125		1-1/8	-183		7/8	-241		1-1/4	10-24	.437	.312
-10		1	-68		1/2	-126		1-1/4	-184		1	-242		1-1/2	10-32	.437	.312
-11	3-48	1/4	-69		9/16	-127		1-1/2	-185		1-1/8	-243		1-3/4	1/4-20	.500	.375
-12		5/16	-70		5/8	-128		1-3/4	-186		1-1/4	-244		2	1/4-28	.500	.375
-13		3/8	-71		3/4	-129		2	-187		1-1/2	-245		2-1/2	5/16-18	.562	.375
-14		7/16	-72		7/8	-130		2-1/4	-188		1-3/4	-246		3	5/16-24	.562	.375
-15		1/2	-73		1	-131		2-1/2	-189		2	-247	9/16-18	3/4	3/8-16	.625	.375
-16		9/16	-74		1-1/8	-132	1/4-28	3/8	-190		2-1/4	-248		1	3/8-24	.625	.375
-17		5/8	-75		1-1/4	-133		7/16	-191		2-1/2	-249		1-1/4	7/16-14	.625	.375
-18		3/4	-76		1-1/2	-134		1/2	-192		3	-250		1-1/2	7/16-20	.625	.375
-19		7/8	-77	8-32	1/4	-135		9/16	-193	3/8-24	1/2	-251		1-3/4	1/2-13	.750	.437
-20		1	-78		5/16	-136		5/8	-194		9/16	-252		2	1/2-20	.750	.437
-21	4-40	1/4	-79		3/8	-137		3/4	-195		5/8	-253		2-1/2	9/16-18	.750	.437
-22		9/16	-80		7/16	-138		7/8	-196		3/4	-254		3	7/16-20	.750	.437
-23		3/8	-81		1/2	-139		1	-197		7/8	-255	9/16-20	3/4	5/8-11	.875	.437
-24		7/16	-82		9/16	-140		1-1/8	-198		1	-256		1	3/4-10	1.000	.500
-25		1/2	-83		5/8	-141		1-1/4	-199		1-1/8	-257		1-1/4	3/4-16	1.000	.500
-26		9/16	-84		3/4	-142		1-1/2	-200		1-1/4	-258		1-1/2			
-27		5/8	-85		7/8	-143		1-3/4	-201		1-1/2	-259		1-3/4			
-28		3/4	-86		1	-144		2	-202		1-3/4	-260		2			
-29		7/8	-87		1-1/8	-145		2-1/4	-203		2	-261		2-1/2			
-30		1	-88		1-1/4	-146		2-1/2	-204		2-1/4	-262		3			
-31	4-48	1/4	-89		1-1/2	-147		3	-205		2-1/2	-263	5/8-11	1			
-32		5/16	-90	10-24	1/4	-148	5/16-18	3/8	-206		3	-264		1-1/4			
-33		3/8	-91		5/16	-149		7/16	-207	7/16-14	1/2	-265		1-1/2			
-34		7/16	-92		3/8	-150		1/2	-208		5/8	-266		1-3/4			
-35		1/2	-93		7/16	-151		9/16	-209		3/4	-267		2			
-36		9/16	-94		1/2	-152		5/8	-210		1	-268		2-1/2			
-37		5/8	-95		9/16	-153		3/4	-211		1-1/8	-269		3			
-38		3/4	-96		5/8	-154		7/8	-212		1-1/4	-270	5/8-18	1			
-39		7/8	-97		3/4	-155		1	-213		1-1/2	-271		1-1/4			
-40		1	-98		7/8	-156		1-1/8	-214		1-3/4	-272		1-1/2			
-41	5-40	1/4	-99		1	-157		1-1/4	-215		2	-273		1-3/4			
-42		5/16	-100		1-1/8	-158		1-1/2	-216		2-1/4	-274		2			
-43		3/8	-101		1-1/4	-159		1-3/4	-217		2-1/2	-275		2-1/2			
-44		7/16	-102		1-1/2	-160		2	-218		3	-276		3			
-45		1/2	-103	10-32	1/4	-161		2-1/2	-219	7/16-20	1/2	-277	3/4-10	1			
-46		9/16	-104		5/16	-162		3	-220		5/8	-278		1-1/4			
-47		5/8	-105		3/8	-163	5/16-24	3/8	-221		3/4	-279		1-1/2			
-48		3/4	-106		7/16	-164		7/16	-222		1	-280		1-3/4			
-49		7/8	-107		1/2	-165		1/2	-223		1-1/8	-281		2			
-50		1	-108		9/16	-166		9/16	-224		1-1/4	-282		2-1/2			
-51	6-32	1/4	-109		5/8	-167		5/8	-225		1-1/2	-283		3			
-52		5/16	-110		3/4	-168		3/4	-226		1-3/4	-284	3/4-16	1			
-53		3/8	-111		7/8	-169		7/8	-227		2	-285		1-1/4			
-54		7/16	-112		1	-170		1	-228		2-1/4	-286		1-1/2			
-55		1/2	-113		1-1/8	-171		1-1/8	-229		2-1/2	-287		1-3/4			
-56		9/16	-114		1-1/4	-172		1-1/4	-230		3	-288		2			
-57		5/8	-115		1-1/2	-173		1-1/2	-231	1/2-13	3/4	-289		2-1/2			
-58		3/4	-116		2	-174		1-3/4	-232		1	-290		3			

HIGH TECHNOLOGY PLASTIC THUMB SCREWS (continued)

KNURLED THUMB SCREWS

Part No. DF226 - (Size Code No.) - (Material Code No.)
(below) (page 35)

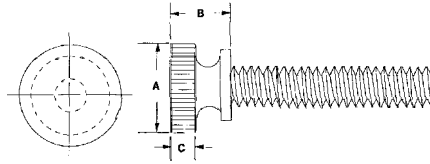

Thread Size	A	B	C	Thread Size	A	B	C
4-40	.300	.280	.120	1/4-28	.540	.365	.155
6-32	.360	.275	.125	5/16-18	.625	.406	.171
8-32	.425	.305	.140	3/8-16	.687	.437	.187
10-24	.425	.325	.140	1/2-13	.750	.468	.203
10-32	.425	.325	.140	1/2-20	.750	.468	.203
1/4-20	.540	.365	.155				

SLOTTED THUMB SCREWS

Part No. D227 - (Size Code No.) - (Material Code No.)
(below) (page 35)

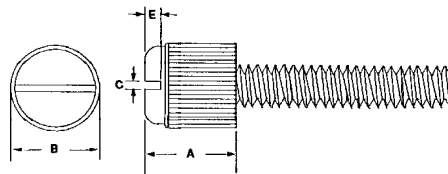

Thread Size	A	B	C	E	Thread Size	A	B	C	E
4-40	.216	.317	.039	.045	1/4-28	.326	.492	.070	.088
6-32	.250	.348	.042	.051	5/16-18	.348	.562	.078	.095
8-32	.280	.381	.049	.059	3/8-16	.382	.625	.087	.112
10-24	.317	.412	.056	.068	1/2-13	.500	.750	.098	.146
10-32	.317	.412	.056	.068	1/2-20	.500	.750	.098	.146
1/4-20	.326	.492	.070	.088					

KNURLED AND SLOTTED THUMB SCREWS SIZE CODE CHART

Size Code No.	Thread Size	Length	Size Code No.	Thread Size	Length	Size Code No.	Thread Size	Length	Size Code No.	Thread Size	Length	Size Code No.	Thread Size	Length
-1	4-40	1/4	-19	6-32	7/8	-37	10-24	5/8	-55	10-32	1 1/2	-73	5/16-18	1 1/2
-2	4-40	5/16	-20	6-32	1	-38	10-24	3/4	-56	10-32	2	-74	5/16-18	2
-3	4-40	3/8	-21	8-32	1/4	-39	10-24	7/8	-57	1/4-20	1/2	-75	3/8-16	1/2
-4	4-40	7/16	-22	8-32	5/16	-40	10-24	1	-58	1/4-20	3/4	-76	3/8-16	3/4
-5	4-40	1/2	-23	8-32	3/8	-41	10-24	1 1/4	-59	1/4-20	1	-77	3/8-16	1
-6	4-40	9/16	-24	8-32	7/16	-42	10-24	1 1/2	-60	1/4-20	1 1/4	-78	3/8-16	1 1/4
-7	4-40	5/8	-25	8-32	1/2	-43	10-24	2	-61	1/4-20	1 1/2	-79	3/8-16	1 1/2
-8	4-40	3/4	-26	8-32	9/16	-44	10-32	1/4	-62	1/4-20	2	-80	3/8-16	2
-9	4-40	7/8	-27	8-32	5/8	-45	10-32	5/16	-63	1/4-28	1/2	-81	1/2-13	1/2
-10	4-40	1	-28	8-32	3/4	-46	10-32	3/8	-64	1/4-28	3/4	-82	1/2-13	1
-11	6-32	1/4	-29	8-32	7/8	-47	10-32	7/16	-65	1/4-28	1	-83	1/2-13	1 1/2
-12	6-32	5/16	-30	8-32	1	-48	10-32	1/2	-66	1/4-28	1 1/4	-84	1/2-13	2
-13	6-32	3/8	-31	10-24	1/4	-49	10-32	9/16	-67	1/4-28	1 1/2	-85	1/2-13	2 1/2
-14	6-32	7/16	-32	10-24	5/16	-50	10-32	5/8	-68	1/4-28	2	-86	1/2-20	1/2
-15	6-32	1/2	-33	10-24	3/8	-51	10-32	3/4	-69	5/16-18	1/2	-87	1/2-20	1
-16	6-32	9/16	-34	10-24	7/16	-52	10-32	7/8	-70	5/16-18	3/4	-88	1/2-20	1 1/2
-17	6-32	5/8	-35	10-24	1/2	-53	10-32	1	-71	5/16-18	1	-89	1/2-20	2
-18	6-32	3/4	-36	10-24	9/16	-54	10-32	1 1/4	-72	5/16-18	1 1/4	-90	1/2-20	2 1/2