

FLUOROPLASTIC SPACERS

*Available in the following materials:

Material Code No.	Material Name	Material Code No.	Material Name
-29	Teflon®	-37	Kynar®, (PVDF)
-30	Tefzel®	-40	PFA, (Teflon®)
-31	FEP®	-41	Halar®
-32	PCTFE		

*Available in other materials.
See materials list in index.
Other sizes available on request.

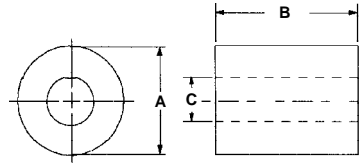

ROUND SPACERS

Part No. D208 - (Size Code No.) - (Material Code No.)

Size Code No.	A	B	C	Screw Size	Size Code No.	A	B	C	Screw Size
-1	.145	.390	.095	#2	-45	.500	.250	.190	#10
-2	.200	.125	.100	#4	-46	.500	.375	.190	#10
-3	.225	.145	.115	#4	-47	.500	.255	.260	#1/4
-4	.230	.125	.155	#6	-48	.500	1.740	.190	#10
-5	.245	.390	.195	#10	-49	.510	.310	.150	#6
-6	.250	.280	.190	#10	-50	.550	.435	.320	#5/16
-7	.250	.185	.075	#2	-51	.570	.250	.165	#8
-8	.250	.155	.165	#8	-52	.570	.275	.190	#10
-9	.250	.715	.125	#4	-53	.570	.030	.450	#7/16
-10	.255	.190	.130	#4	-54	.580	.250	.375	#3/8
-11	.270	.135	.170	#8	-55	.612	.235	.060	—
-12	.270	.130	.175	#8	-56	.605	.370	.165	#8
-13	.300	.135	.210	#10	-57	.615	.090	.250	#1/4
-14	.305	.155	.125	#4	-58	.625	.125	.440	#7/16
-15	.350	.250	.170	#8	-59	.635	.875	.265	#1/4
-16	.350	.062	.180	#8	-60	.700	.140	.600	#9/16
-17	.365	.062	.125	#4	-61	.735	.250	.200	#10
-18	.365	.120	.120	#4	-62	.735	.375	.500	#7/16
-19	.370	.595	.250	#1/4	-63	.745	.062	.310	#5/16
-20	.375	.250	.255	#1/4	-64	.750	.310	.485	#7/16
-21	.375	.100	.165	#8	-65	.750	.820	.580	#9/16
-22	.375	.500	.250	#1/4	-66	.750	1.500	.255	#1/4
-23	.375	.110	.105	#4	-67	.750	.100	.315	#5/16
-24	.375	.340	.250	#1/4	-68	.750	.155	.515	#1/2
-25	.375	.812	.174	#8	-69	.870	.255	.250	#1/4
-26	.380	.255	.280	#1/4	-70	.870	.130	.395	#3/8
-27	.405	.250	.315	#5/16	-71	.870	.130	.440	#7/16
-28	.405	.375	.330	#5/16	-72	.940	.062	.275	#1/4
-29	.425	1.000	.312	#5/16	-73	.945	.062	.240	#12
-30	.430	.250	.205	#10	-74	.945	.065	.290	#1/4
-31	.460	.140	.315	#5/16	-75	.975	.420	.320	#5/16
-32	.490	.220	.250	#1/4	-76	1.000	.195	.800	#3/4
-33	.490	.425	.150	#6	-77	1.000	.165	.760	#3/4
-34	.495	.180	.200	#10	-78	1.000	.100	.405	#3/8
-35	.495	.435	.260	#1/4	-79	1.000	.125	.310	#5/16
-36	.490	.110	.120	#4	-80	1.035	.205	.900	#7/8
-37	.495	.415	.190	#10	-81	1.250	.250	.500	#7/16
-38	.495	.500	.190	#10	-82	1.250	.250	1.000	#1
-39	.495	.620	.190	#10	-83	1.250	.250	.875	#7/8
-40	.495	.925	.250	#1/4	-84	1.250	.250	.625	#5/8
-41	.500	.165	.165	#8	-85	1.250	.250	.750	#3/4
-42	.500	.030	.375	#3/8	-86	1.320	.250	.640	#5/8
-43	.500	.750	.310	#5/16	-87	1.380	.505	.625	#5/8
-44	.500	.187	.195	#10	-88	1.510	.250	.765	#3/4