

# MOLDED NYLON METRIC FLAT WASHERS

\*Available in the following materials:

Material Code No.	Material Name
-18	Nylon 6/6, (natural)
-78	Nylon 6/6, (black)

Part No. GM117 - (Size Code No.) - (Material Code No.)

Size Code No.	Thread Size	A	B	T	Size Code No.	Thread Size	A	B	T
-1	M2	5,00	2,15	0,80	-6	M5	11,00	5,30	1,00
-2	M2,5	5,60	2,65	0,80	-7	M6	12,00	6,40	1,50
-3	M3	8,00	3,20	0,80	-8	M8	18,00	8,40	2,00
-4	M3,5	8,00	3,70	0,80	-9	M8,5	25,00	8,50	2,00
-5	M4	9,00	4,30	0,80	-10	M10	22,00	10,50	2,50

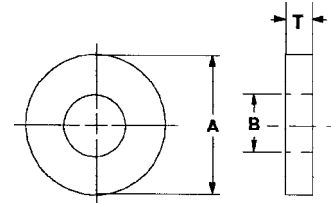

Tolerance on all dimensions  
+/- .25mm.

# MOLDED FLAT WASHERS

\*Available in the following materials:

Material Code No.	Material Name	Material Code No.	Material Name	Material Code No.	Material Name
-3	Lexan®, (clear)	-32	PCTFE	-194	Nylon 46, 30% Glass-filled, Heat Stabilized
-5	Ultem® 1000	-35	Noryl®	-195	Nylon 46, 30% Glass-filled, Flame Retardant, Heat Stabilized
-6	Ultem® 2300, (black)	-37	Kynar®, (PVDF)	-226	Radel® A200, Polyethersulfone
-11	Polypropylene	-40	PFA, (Teflon®)	-228	Radel® AG330, 30% Glass-filled
-13	Polyethylene	-60	Nylon 6/6, 30% Short Glass-filled	-229	Radel® R5000, Polyphenylsulfone
-14	ABS	-74	Isoplast™ 40% Long glass Fiber		
-18	Nylon 6/6, (natural)	-77	Ultem® 2300, (natural)		
-24	Delrin®	-78	Nylon 6/6, (black)		

\*Available in other materials.  
See materials list in index.  
Other sizes available on request.

Part No. G1200 - (Size Code No.) - (Material Code No.)

Size Code No.	I.D. B	O.D. A	Thick T	Screw Size	Size Code No.	I.D. B	O.D. A	Thick T	Screw Size
-1	.031	.125	.020	-	-11	.189	.318	.125	#10
-2	.062	.250	.093	#0	-12	.200	.437	.062	#10
-3	.115	.281	.047	#4	-13	.218	.273	.125	-
-4	.140	.312	.047	#6	-14	.253	.312	.125	1/4
-5	.140	.500	.032	#6	-15	.255	.437	.062	1/4
-6	.158	3/8	.135	-	-16	.260	.562	.062	1/4
-7	.163	.377	.125	-	-17	.307	.583	1/8	-
-8	.163	.500	.125	-	-18	.406	.812	.062	-
-9	.165	.625	.125	#8	-19	.525	.730	.125	1/2
-10	.170	.375	.062	#8	-20	.562	.750	.125	9/16

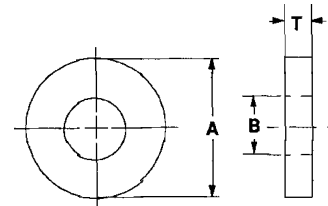

# MOLDED FLAT WASHERS

Available in the following materials:

Material Code No.	Material Name
-48	Ryton®, PPS, 40% Short Glass-filled
-228	Radel® AG330, 30% Glass-filled
-520	PPS, 30% Carbon Fiber, (black)
-820	Isoplast™, 30% Short Glass Fiber, (gray)
-824	Isoplast™, 30% Short Glass Fiber, (natural)

Part No. FW126 - 100 - (Material Code No.)

