



Blind Press Nuts

Series CFB & CFBS



CFB & CFBS blind, sealed-thread, press nuts are designed to provide extended thread lengths in thin sheet metal. Press nuts provide a seal against the entrance of dirt, oils, moisture, and corrosive atmospheres. They are usually more economical to use than nut and screw-type hardware that require elaborate seals and special assembly procedures.

Series	Material	Finish
CFB	Heat-treated Carbon Steel	Zinc* Clear
CFBS	300 Series Stainless Steel	Passivated ASTM A380

*Spec. ASTM B633-85

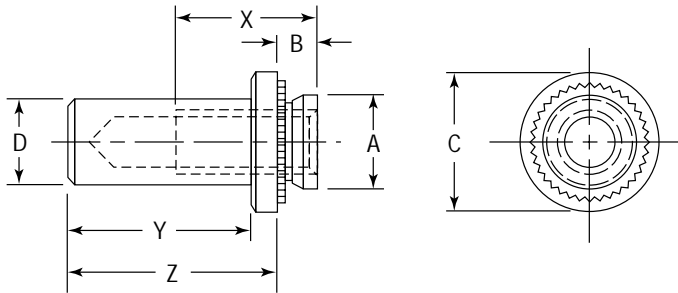

These fasteners are identical to industry standards in all respects. Identical dimensions and hole sizes permit them to be fed through automatic insertion equipment. Captive blind press nuts are available in sizes from 4-40 to 1/4-20 (M3 to M6) in both carbon and stainless steel.

Use In: CFB – Materials with HRB-80 or less.

CFBS – Materials with HRB-70 or less.

Dimensions & Specifications

Thread Size	Part Number		Barrel Dia. D Max.	Min.	Shank Dia. A Max.	Y Max.	B Max.	C ±.01 in. (±.25 mm)	Z ±.01 in. (±.25 mm)	X Depth Full Thread Min.
	Carbon Steel	Stainless Steel								
INCH (in.)	#4-40	CFB440-1	.149	.040	.165	.335	.038	.25	.38	.19
		CFB440-2		.056						
	#6-32	CFB632-1	.169	.040	.186	.335	.038	.28	.38	.22
		CFB632-2		.056						
	#8-32	CFB832-1	.204	.040	.212	.385	.038	.31	.44	.27
		CFB832-2		.056						
	#10-32	CFB1032-1	.235	.040	.249	.385	.038	.34	.44	.28
		CFB1032-2		.056						
	1/4-20	CFB420-1	.305	.056	.343	.500	.054	.43	.56	.34
		CFB420-2		.090						
METRIC (mm)	M3 x 0.5	CFBM3-1	3.8	1.0	4.22	8.5	0.97	6.35	9.6	4.8
		CFBM3-2		1.4			1.37			
	M4 x 0.7	CFBM4-1	5.2	1.0	5.38	9.8	0.97	7.95	11.2	6.9
		CFBM4-2		1.4			1.37			
	M5 x 0.8	CFBM5-1	6.0	1.0	6.38	9.8	0.97	8.75	11.2	7.1
		CFBM5-2		1.4			1.37			
	M6 x 1.0	CFBM6-1	7.8	1.4	8.75	12.7	1.37	11.10	14.3	8.6
		CFBM6-2		2.3			2.21			

Continued on next page.



Blind Press Nuts

Series CFB & CFBS

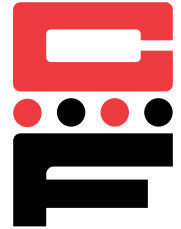

Continued from previous page.

Installation & Performance Data

		Cold-rolled Steel			5052-H34 Aluminum			
Thread Size	Min.							
		Installation Force (lbs.)	Pushout (lbs.)	Torque-out (in.-lbs.)	Installation Force (lbs.)	Pushout (lbs.)	Torque-out (in.-lbs.)	
INCH (in.)	#4-40	.040	2500-2700	125	13	1500-1600	100	12
	#6-32	.040	3000-3100	130	18	1850	105	17
	#8-32	.040	3400-3600	135	30	2000	110	25
	#10-32	.040	4000	140	35	2100	110	34
	1/4-20	.062	6000	400	105	4000	315	100
		Cold-rolled Steel			5052-H34 Aluminum			
Thread Size	Min.	Installation Force (kN)	Pushout (N)	Torque-out (N•m)	Installation Force (kN)	Pushout (N)	Torque-out (N•m)	
		M3	1.0	11	560	1.5	7	440
M4	1.0	15	600	3.4	9	490	2.8	
M5	1.0	17	620	4.0	10	490	3.8	
M6	1.6	25	1780	11.9	18	1400	11.3	