

Co-Extruded Self Retaining Screw Spacers

- Unique bi-material design, patent pending.
- Tight fit with low insertion force.
- Works with #4 - #8 (M3-M4) screw sizes.

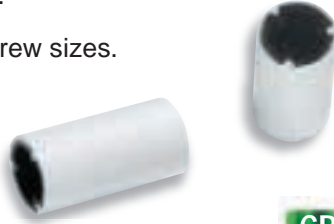

CRS-1 #4 Screws

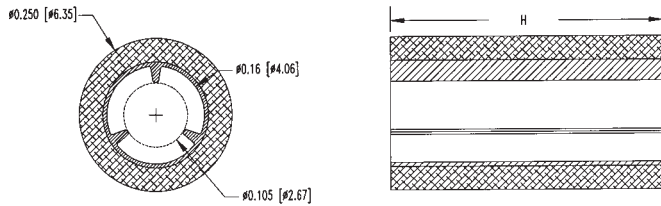

CRS-2 #M3 Screws

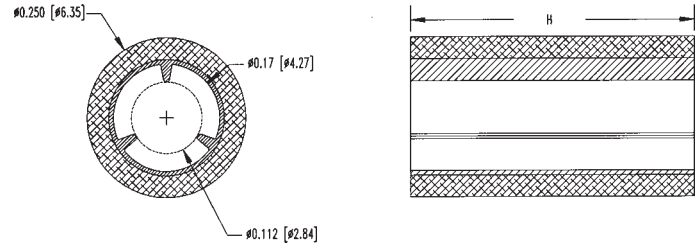

CRS-3 #6 Screws

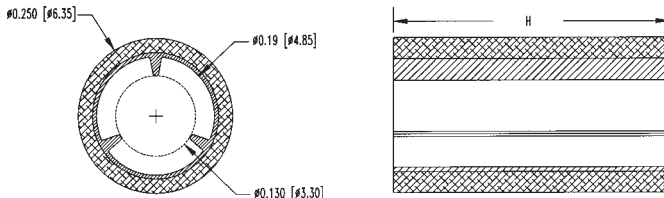

CRS-4 M4, #8 Screws

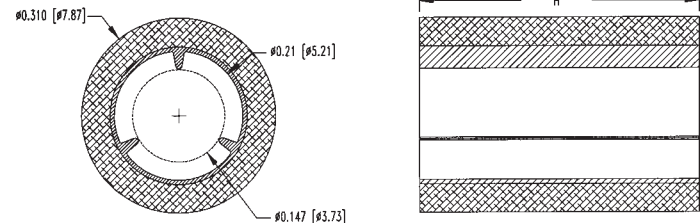

"H" DIMENSION	PRICE CODE CRS-1 THRU CRS-4
.050-.075 (1.25-1.9)	W
.080-.150 (2.0-3.8)	X
.155-.230 (4.0-5.8)	X
.235-.310 (6.0-7.9)	Y
.315-.380 (8.0-9.7)	Z
.385-.495 (9.8-12.6)	ZZ
.500-.750 (12.7-19.1)	ZZZ
.755-1.250 (19.2-31.8)	ZZZZ

Material Specifications:
Natural, Rigid and Semi-Rigid PVC material,
U.L. Rated 94V-0

Oxygen Rating Index: Over 45%
Standard Drawing Tolerances, unless otherwise indicated:
O.D. ±.005 (.13), I.D. ±.005 (.13)
"H" Dim: 1/16-1/2 (1.6-12.7) is ±.005 (.13)
"H" Dim: 9/16-1.0 (14.3-25.4) is ±.010 (.25)

